

Step 1. Install Intune

- a. Connect to the internet and select the Windows icon at the bottom of your screen

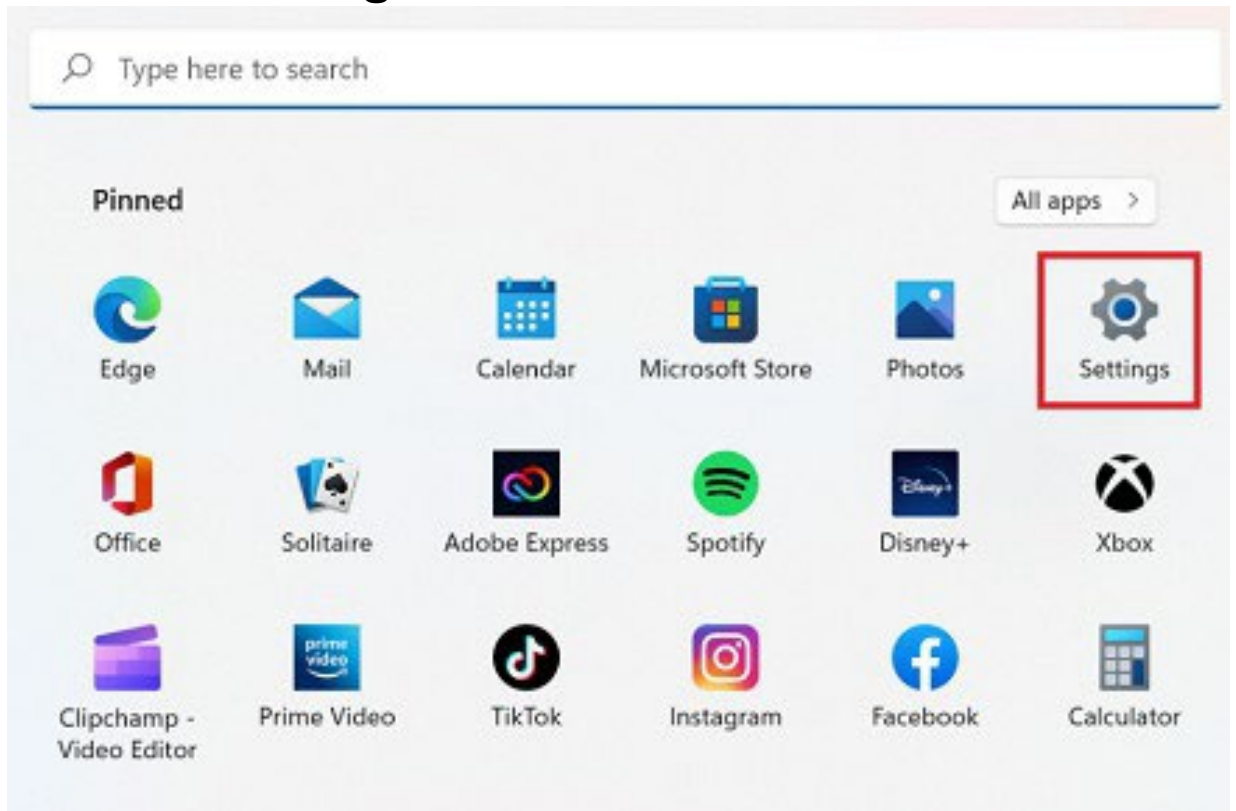

- b. Select the **Settings** icon



C. Select **Accounts**

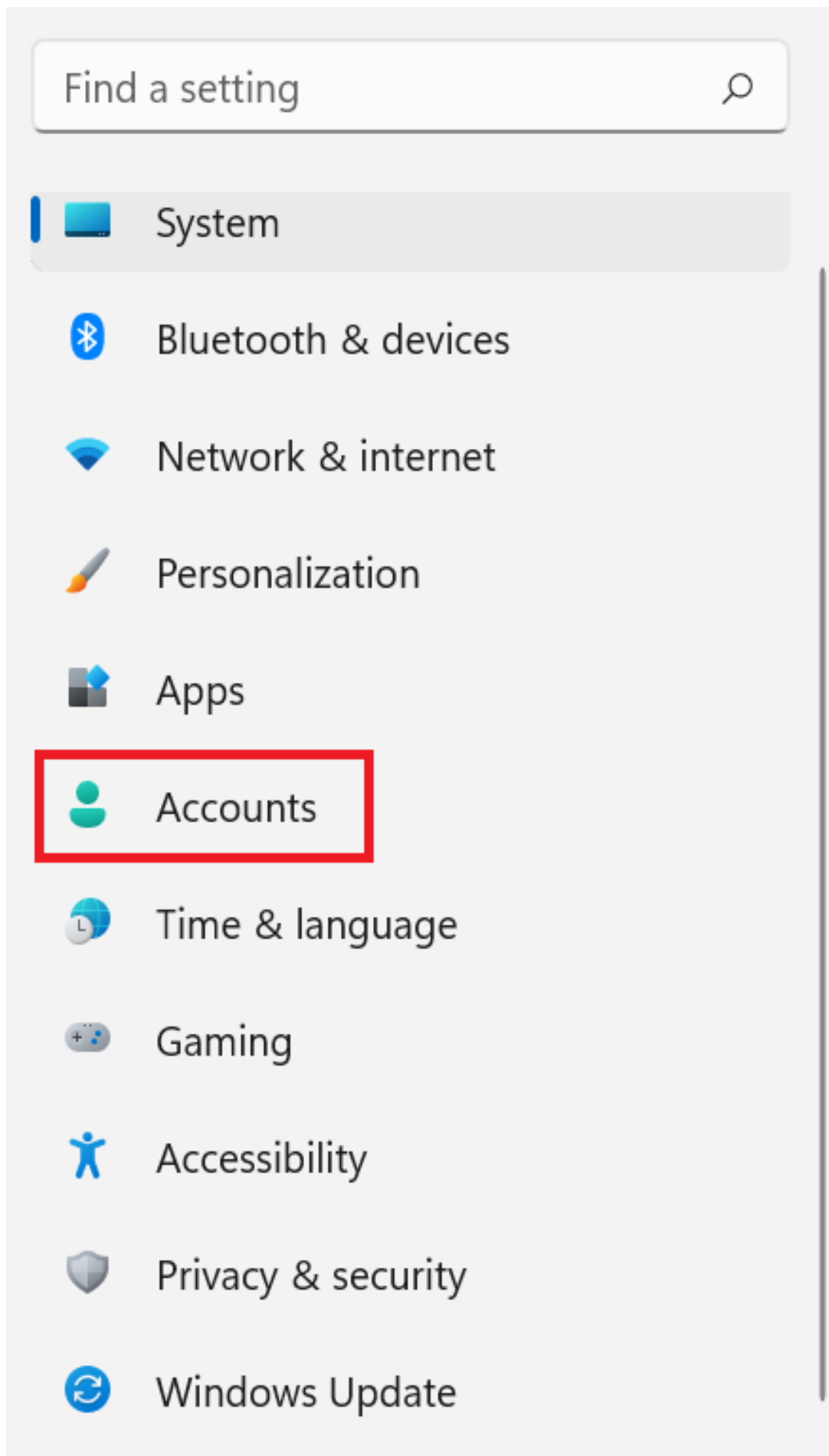

- d. Select **Access work or school**. If your account is already listed, select it and then select **Disconnect**. Then select **Connect**.

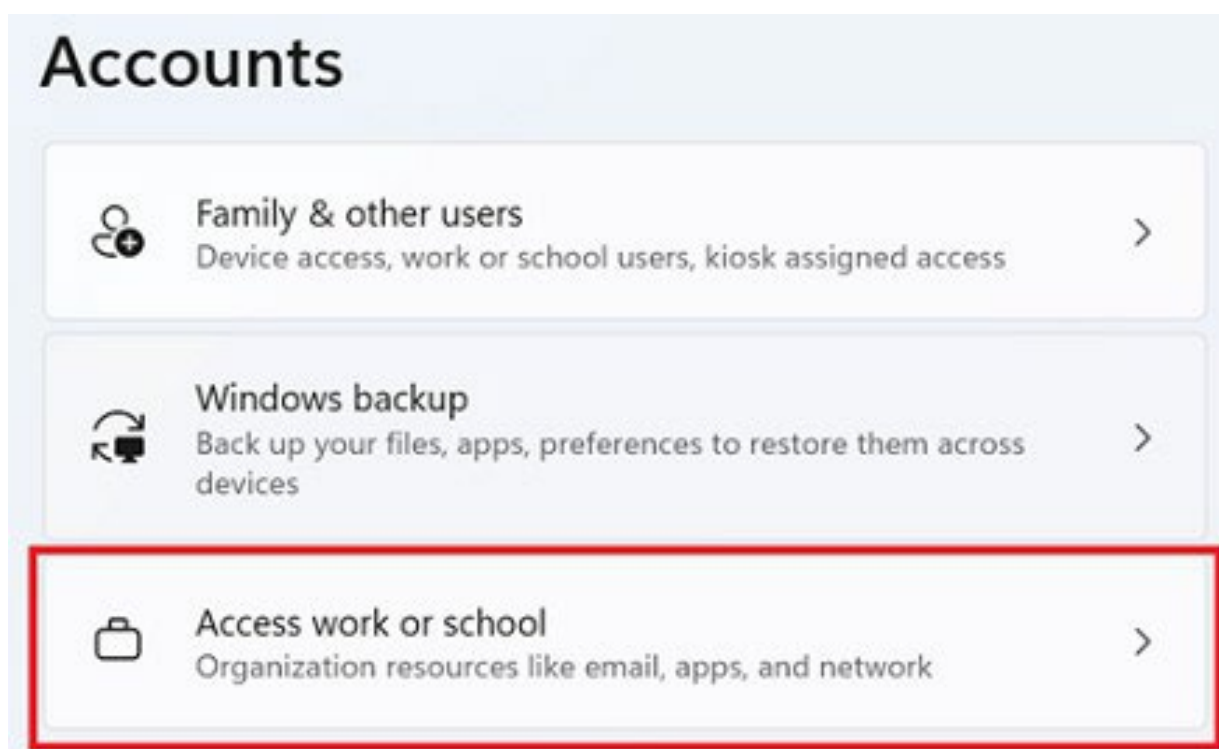

- e. Enter your school Username@eq.edu.au email address and select **Next**.

Set up a work or school account

You'll get access to resources like email, apps, and the network. Connecting means your work or school might control some things on this device, such as which settings you can change. For specific info about this, ask them.

Next

- f. Please enter your username, password, accept the terms and conditions, and **Sign in**.

Managed Internet Service

Sign in with your username and password

Username *

Password *

☒ I agree to the [conditions of use](#)

Sign in

[Change my password](#)

- g. Please select **Done**.

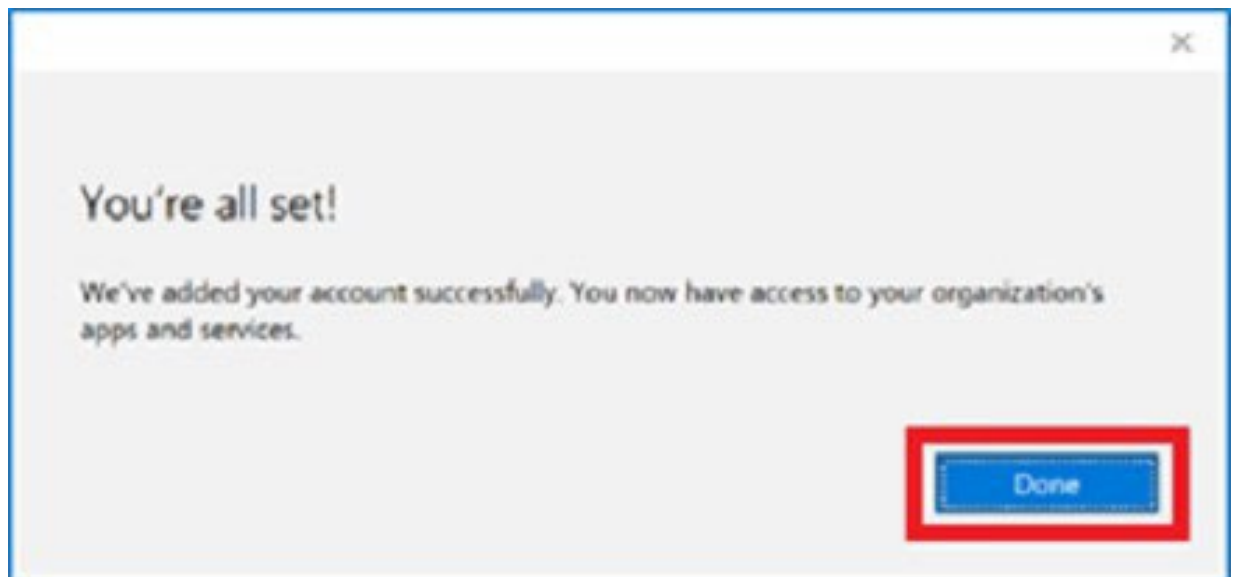

- h. Check your account has been added. Your account details will be displayed.

